

HIGH EFFICIENCY DOUBLE MOVEMENT BLENDER

FY series - Pharmaceutical

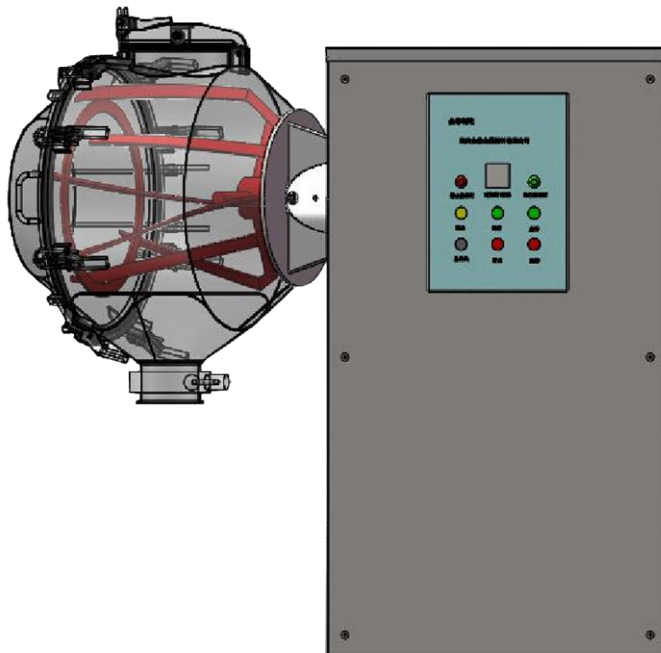

Blender patent No: ZL20162013-1
Revision date: Apr.12, 2023



FEKMASS TECHNOLOGY INC
304, Building 2, No.81 North Jingsan road,
Zhengzhou 450000, China.
Tel: +86 371 87093270
www.fekmass.com
info@fekmass.com

WHY FEKMASS BLENDER ?

Double movement mixing, increase efficiency by 70%.

With 80% loading rate, very-high mixing uniformity.

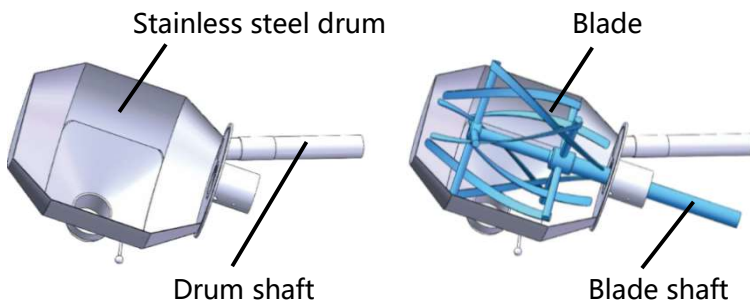

Our advantages:

- Double movement when mixing
- Special blade design
- Separate rotating for drum shaft
- Separate rotating for blade shaft

Features:

- Double movement mixing, very-high mixing uniformity
- High efficiency, save 70% mixing time
- High loading rate, 80% of the drum volume
- Meet the request of fine-scale mixing for new materials
- Does not damage the shape of the original particle
- The light powder and heavy powder are easy to mix evenly
- The trace elements are easy to mix evenly

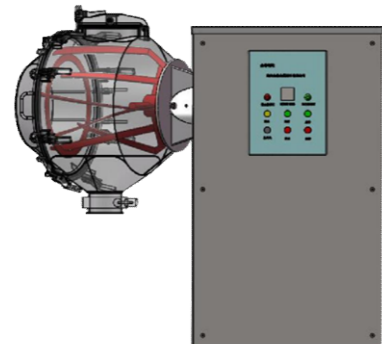

Compared with other blenders:



V type mixer
Small volume
45% low loading rate



3-Dimensional blender
Small volume
40% low loading rate



Single cone mixer
Volum < 5000L
60% loading rate



Ribbon mixer
Bad mixing uniformity
65% loading rate

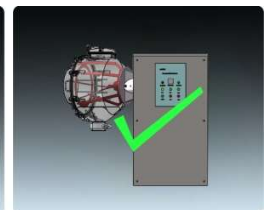

FEKMASS FY blender
Volume up to 8000L
80% loading rate

WHAT MATERIALS CAN BE MIXING ?

Application area & Materials

- Pharmaceutical
- Pharmaceutical intermediates
- Health products
- Food
- Food additives
- Cosmetic
- Pet food
- Pesticide
- Biologicals
- Fertilizer
- Chemicals
- Diamond superhard material
- Dyestuff/Pigment
- Fingernail oil
- Life science
- Environment



SELECT YOUR SUITABLE MODEL

Model	Drum Volume (L)	Loading Volume (L)	Drum rotation speed (r/min)	Blade rotation speed (r/min)	Motor (Kw)	Dimension (mm)	Total weight (Kgs)
FY-100	100	80	21	46	1.1	1420*600*1050	330
FY-200	200	160	18	39	2.2	1770*780*1330	550
FY-400	400	320	13	27	2.2	1970*825*1620	700
FY-600	600	480	12	26	3	2230*980*1820	1100
FY-800	800	640	11	23	4	2380*1020*1920	1300
FY-1000	1000	800	10	21	5.5	2540*1100*1940	1500

Notes:

Above dimensions are for reference only.

Accept custom size and larger size.

Possible POLLUTION problem of the powders ?

To prevent the pollution of powders when blender running, we made some extremely effective measures.

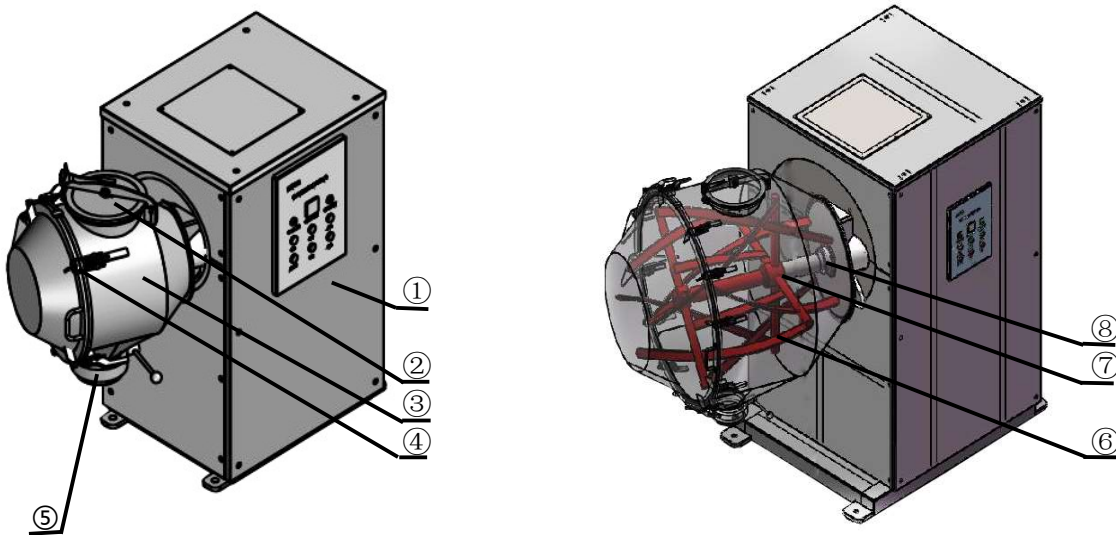

- ① Blender body (Mat. SUS304, optional SUS316L)
- ② Feed inlet valve (Mat. SUS304, option SUS316L, Gasket ring mat. PTFE & Silicagel)
- ③ Blender drum (Mat. SUS304, option SUS316L)
- ④ Cleaning opening (Gasket ring mat. PTFE & Silicagel)
- ⑤ Discharge outlet valve (Mat. SUS304, option SUS316L, Gasket ring mat. PTFE & Silicagel)
- ⑥ Mixing blades (Mat. SUS304, option SUS316L)
- ⑦ The Gasket ring of joint place of the blade and shaft (mat. PTFE & Silicagel)
- ⑧ The Gasket ring of joint place of the flange and shaft (mat. PTFE & Silicagel)

Remarks:

The material of gasket rings with food and pharmaceutical grade PTFE & Silicagel.

The leakproofness of the gasket ring with very high grade, powders will not leak, other dusts will not enter.

The CLEANING of the blender drum

Cleaning steps:

1. Open the cleaning opening after the blender shutdown.
2. Spray the inner space of the drum by the water gun with water & little detergent.
3. Blow-dry by dryer with hot wind.



④ Cleaning opening

AFTER-SALES SERVICE

Warranty service: 1 year

Strong technical team, Professional after-sales service

Help you solve any difficulties during the mixing process.



CONTACT FEKMASS

FEKMASS TECHNOLOGY INC
304, Building 2, No.81 North Jingsan road,
Zhengzhou 450000, China.
Tel: +86 371 87093270
www.fekmass.com
info@fekmass.com